

BINCKLEY LAND SURVEYING

6375 WINDSONG WAY, NASHPORT, OHIO 43830
 PHONE (740) 455 - 3736

SITUATE IN THE STATE OF OHIO, COUNTY OF GUERNSEY, TOWNSHIP OF ADAMS,
 AND BEING A PART OF THE NORTHWEST QUARTER OF SECTION # 24, TOWNSHIP 2
 NORTH, RANGE 4 WEST OF THE UNITED STATES MILITARY DISTRICT AND BEING A
 TRACT OF LAND CONVEYED TO DORIS DOLLISON IN O.R. VOL. 395, PG. 306 OF
 GUERNSEY CO. RECORDS.
 GUERNSEY CO. AUDITOR PARCEL # 01 - 02137

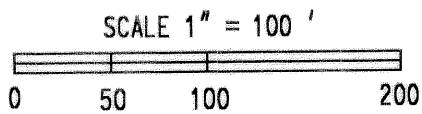
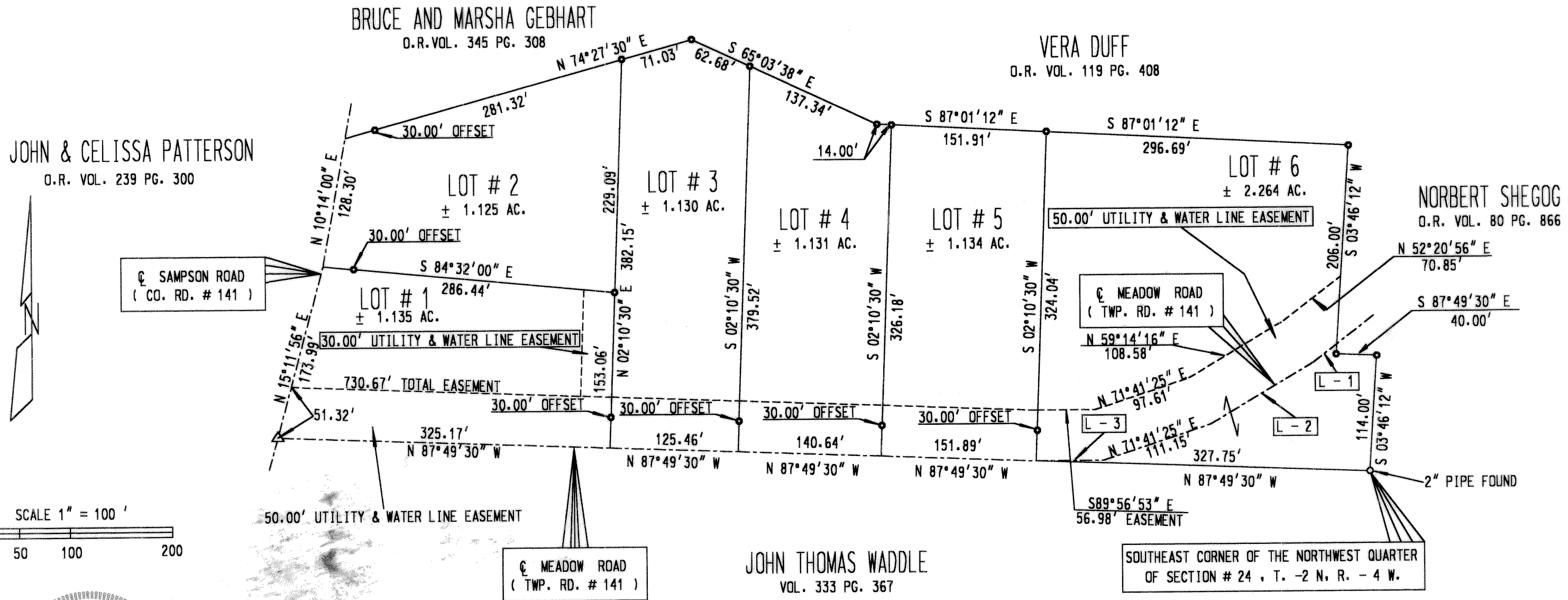

SUNNY BROOKE ACRES

I HEREBY CERTIFY THAT AT THE DIRECTION OF THE OWNERS OF THE REAL ESTATE SHOWN,
 I SURVEYED AND PLATTED 7.919 ACRES OF THE SAME INTO LOTS, AND SAID LOTS ARE
 NUMBERED 1 TO 6 INCLUSIVE, THAT THE FOREGOING REAL ESTATE HAS BEEN NAMED SUNNY BROOKE,
 AND THE DIMENSIONS ARE GIVEN IN FEET AND DECIMAL PARTS THEREOF.

Donald E. Binckley II 11-25-2006
 DONALD E. BINCKLEY II P. S. 7879 DATE

DESCRIPTION
 APPROVED
 By *S. Jameson* 12/8/06
 Tony Brown,
 Surveyor

NOTE : ALL DRAINAGE SHALL BE ALONG LOT LINES.
 REFERENCES : TAX MAPS, DEEDS OF RECORD, U.S.G.S. QUADRANGLE MAP, PREVIOUS SURVEYS BY LLOYD BROCKWELL
 DATED 7-6-1978 AND JOSEPH SPILKER DATED 1-28-1978 & 6-17-1977.

BASIS OF BEARING : BEARINGS ON THIS PLAT ARE ASSUMED ON THE SOUTH LINE OF THE
 NORTHWEST QUARTER OF SECTION # 24, T. - 2 N., R. - 4 W. IN THE UNITED STATES
 MILITARY DISTRICT . AS BEING N 87°49'30" W AND ARE FOR ANGULAR CALCULATION ONLY.

LEGEND	
△	RAILROAD SPIKE FOUND
○	IRON PIN FOUND FOUND
●	IRON PIN SET

LINE DATA	
L-1	N 52°20'56" E 29.77'
L-2	N 59°14'16" E 117.05'
L-3	S 89°56'53" E 65.97'